

Aldreds
Estate Agents



12 Sparrow Close

Bradwell, NR31 8SG

£215,000



12 Sparrow Close

Bradwell, NR31 8SG

This beautifully presented two-bedroom semi-detached home has been modernised throughout and offers stylish, contemporary living in a quiet cul-de-sac location. The property features an open-plan kitchen/diner, ideal for everyday living, while tasteful updates throughout create a move-in-ready home perfectly suited to first-time buyers, downsizers, or investors alike.

Externally, the property benefits from a private rear garden, detached garage with electricity, and a private driveway providing off-road parking for two to three vehicles. Further advantages include a newly installed boiler fitted in April 2026, along with excellent access to local amenities, schools, and transport links. Offered for sale by a motivated seller, internal viewing is highly recommended.

Entrance Hall

Laminate floor, radiator, double glazed door to front, stairs to first floor, cupboard, access to lounge.

Lounge

14'4" x 12'9" (4.37m x 3.91m)

Carpet floor, double glazed window to front, radiator, access to kitchen/diner.

Kitchen/Diner

16'1" x 8'2" (4.92m x 2.51m)

LVT floor, double glazed windows to rear, double glazed door to side, under stairs cupboard, laminate counter tops with over and under counter storage, space for fridge freezer, dishwasher, integrated oven with gas hob and extractor fan, wall mounted gas boiler.

Landing

Carpet floor, double glazed window to side, access to 2 bedrooms and bathroom, loft hatch, airing cupboard, access to over stairs storage.

Bedroom 1

16'0" x 11'9" (4.90m x 3.60m)

Carpet floor, double glazed window to front, radiator, built in wardrobe with secondary access to over stairs storage.

Bedroom 2

11'9" x 8'11" (3.60m x 2.74m)

Carpet floor, double glazed window to rear, radiator, laminate worktop/built in desk.

Bathroom

Laminate floor, double glazed window to rear, fitted WC and basin with vanity storage, bath tub with wall mounted shower and glass screen, heated towel rail.





Garage

Up and over door, concrete floor, electricity connection, plumbing space for washing machine and space for dryer.

Outside Front

Concrete driveway, path to front door, brick wall boundary.

Outside Rear

Concrete patio, grass lawn, garage, timber shed, timber fence boundaries, access to side and front of the property.

Council Tax

Great Yarmouth Borough Council - Band B

Services

Mains gas, water, electric, drainage

Tenure

Freehold

Location

Bradwell is a popular residential area adjoining Gorleston 2 miles from Great Yarmouth Town centre * There are a variety of local shops * Schools * Medical centre * Regular bus services to the main shopping areas * Indoor swimming pool and recreation areas.

Directions

From the Gorleston office head south along the High Street, at the traffic lights turn right into Church Lane, continue over the roundabout at the next set of traffic lights into Crab Lane, at the 'T' junction turn right into Beccles Road, turn left into Mallard Way, turn left into Lark Way, turn right into Sparrow Close.

What 3 Words

///partner.things.plod

Ref

G18514/05/26



Floor Plan

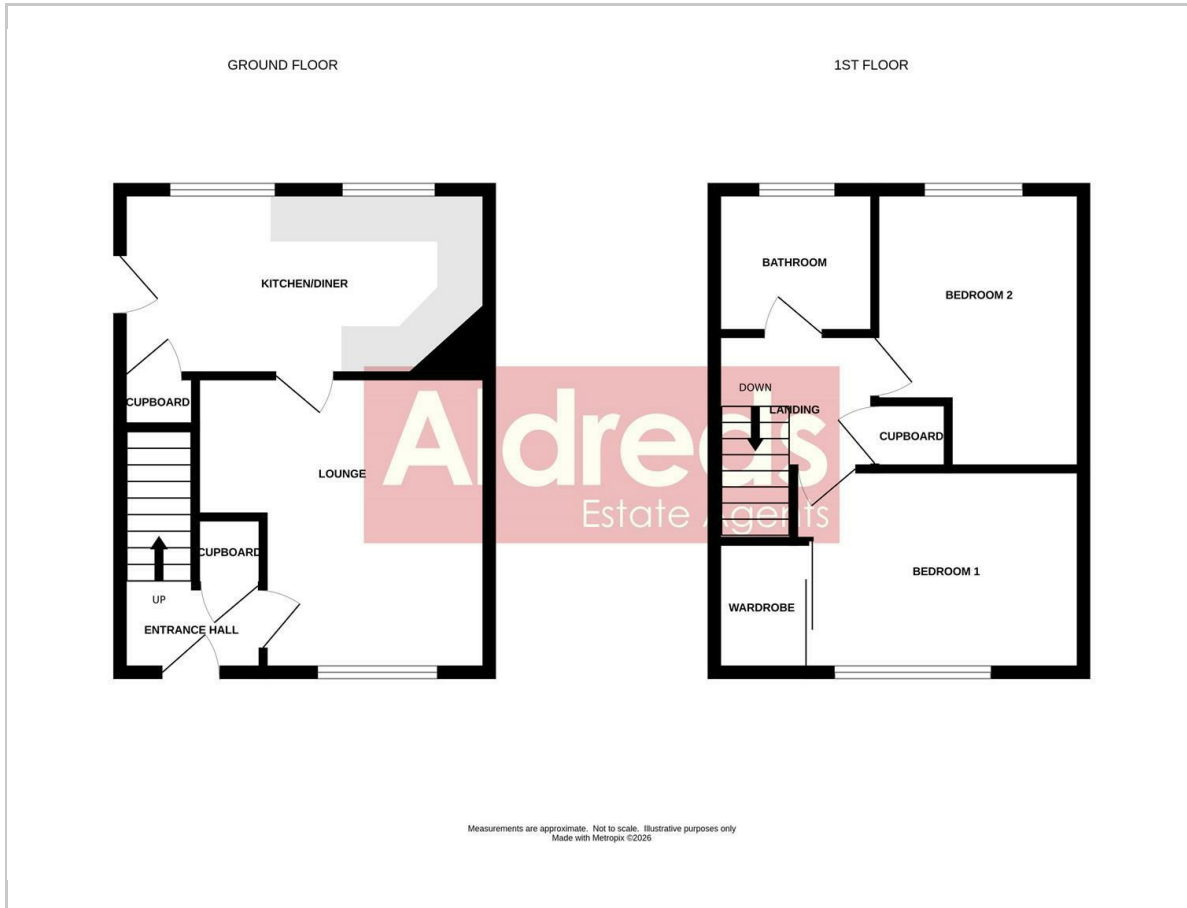

Viewing

Please contact our Aldreds Gorleston Office on 01493 664600 if you wish to arrange a viewing appointment for this property or require further information.

Disclaimer

These particulars are issued on an understanding that all negotiations shall be conducted through Messrs. Aldreds. Please note: Messrs. Aldreds for themselves and for the vendors or lessors of this property whose agents they are given notice that: 1. Particulars are set out as a general outline only for guidance of intending purchasers or lessees, and do not constitute nor constitute part of, an offer or contract. 2. All descriptions, dimensions, references to condition and necessary permissions for use and occupation, and other details are given without responsibility and any intending purchasers or tenants should not rely on them as statements or representations of fact but must satisfy themselves by inspection or otherwise as to the correctness of each of them. 3. No person in the employment of Messrs. Aldreds has any authority to make or give any representation or warranty whatever in relation to this property. 4. If you are proposing to visit the property and are travelling some distance please check with Aldreds on the issue of availability prior to travelling. 5. Aldreds Property Consultants and associated services may offer additional services to the prospective purchaser for which they will be entitled to receive a commission.

Aldreds are pleased to be working with Mortgage Advice Bureau. They're an award-winning mortgage broker with over 1,400 advisers across the UK, and have access to over 12,000 mortgage products from over 90 lenders. Aldreds Estate Agents Ltd receive a commission of £200 on each completed case. Your home may be repossessed if you do not keep up repayments on your mortgage. There may be a fee for mortgage advice. The actual amount you pay will depend upon your circumstances. The fee is up to 1%, but a typical fee is 0.3% of the amount borrowed. Mortgage Advice Bureau is a trading name of Mortgage Seeker Limited which is an appointed representative of Mortgage Advice Bureau Limited and Mortgage Advice Bureau (Derby) Limited which are authorised and regulated by the Financial Conduct Authority. Mortgage Seeker Limited Registered Office: Lovewell Blake, Sixty Six North Quay, Great Yarmouth, Norfolk, NR30 1HE. Registered in England Number: 03721415. 6. Potential purchasers should check with their providers that the broadband and mobile phone coverage they would require is available.

Area Map

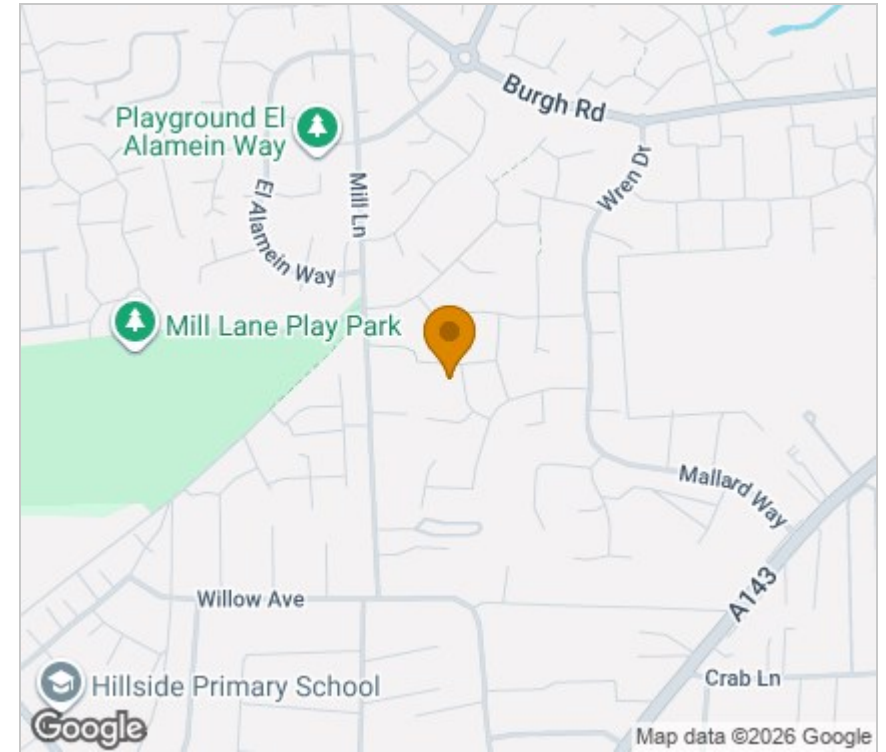

Energy Efficiency Graph

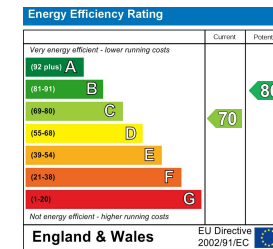

149 High Street, Gorleston, Norfolk, NR31 6RB

Tel: 01493 664600 Email: gorleston@aldreds.co.uk <https://www.aldreds.co.uk/>

Registered in England Reg. No. 08945751 Registered Office: 17 Hall Quay, Great Yarmouth, Norfolk NR30 1HJ

Directors: Mark Duffield B.S.c. FRICS. Dan Crawley MNAEA Paul Lambert MNAEA